

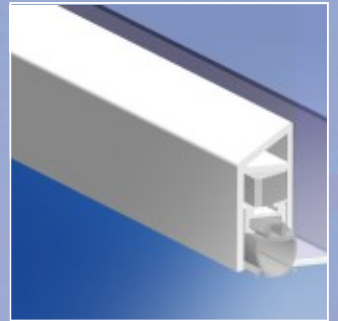

COOKE BROTHERS

High Performance
Ironmongery

-
Glass Door
Products



Architectural Ironmongery for Glass Doors

Glass Door Hinges

Features

- Stainless steel construction
- Non corrosive
- Maximum adjusted door weight 80kg load capacity
- No glass to metal contact
- Available in satin stainless, polished stainless, brass finish, bronze finish. Special finishes available upon request
- Suitable for door thicknesses of 10mm to 12mm
- Fixes with standard M6 countersunk stainless steel socket head screws
- Fixes to door frame with No10 32mm woodscrews



Available in a choice of styles

The Phoenix glass door hinge is available in a variety of styles, based upon other Phoenix hinge ranges;

- 1 Slimline (shown) - 7530
- 2 Loadmaster - 7935
- 3 Concealed bearing range - 7730

Lift-off versions are also available

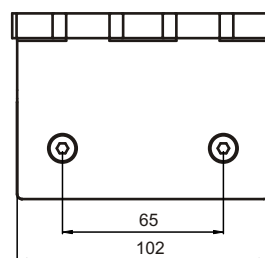
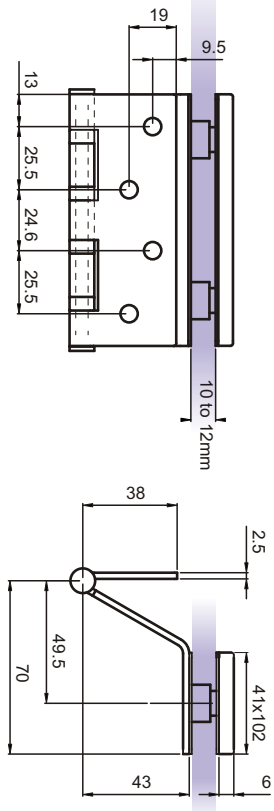
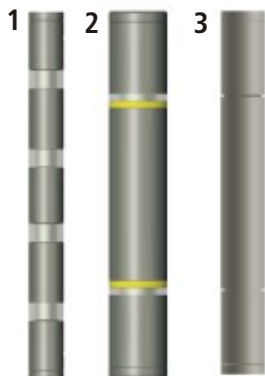

Finishes

Base material



Satin polished stainless steel



Bright polished stainless steel

Applied finishes



Brass electrophoretic lacquer



Bronze electrophoretic lacquer

Glass Door Flush Pulls

Features

- Stainless steel construction
- Non corrosive
- Back to back fixings
- No glass to metal contact
- Available in satin stainless, polished stainless, brass finish, bronze finish. Special finishes available upon request
- Suitable for glass thickness of 10mm to 12mm
- Fixes with standard M6 countersunk stainless steel socket head screws



Available in a choice of styles

The Phoenix glass door pull is available in a variety of styles;

- 1 Back to back sliding flushpull
- 2 Back to back flush pull - shaped finger grip
- 3 Other face plate profiles available upon request

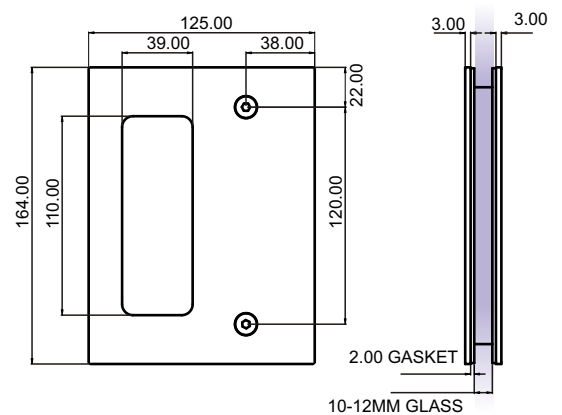

Finishes

Base material



Satin polished stainless steel



Bright polished stainless steel

Applied finishes



Brass electrophoretic lacquer



Bronze electrophoretic lacquer

Architectural Ironmongery for Glass Doors

Sealing System for Glass Doors

For Standard Doors - Retrofit / Face Fit
For 8mm glass doors

Part No DUO GS-8 - Double Actuation
Part No GS-8 - Single Action

- Automatic door seal for 8mm.
- Standard all-glass doors.
- Installation to the opening face of the door.
- Aluminum outer case.
- 15 x 45mm.
- Self-extinguishing silicone seal.

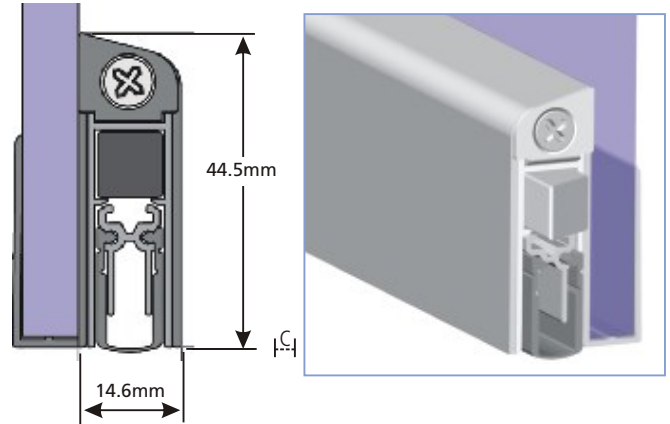

For Standard Doors - Retrofit / Face Fit
For 10 mm glass doors

Part No DUO GS-10 - Double Actuation

- Automatic door seal for 10mm.
- Standard all-glass doors.
- Installation to the opening face of the door.
- Aluminum outer case.
- 16 x 40mm.
- Self-extinguishing silicone seal.

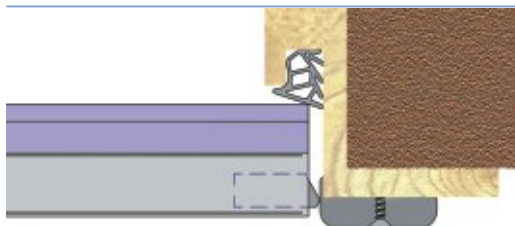
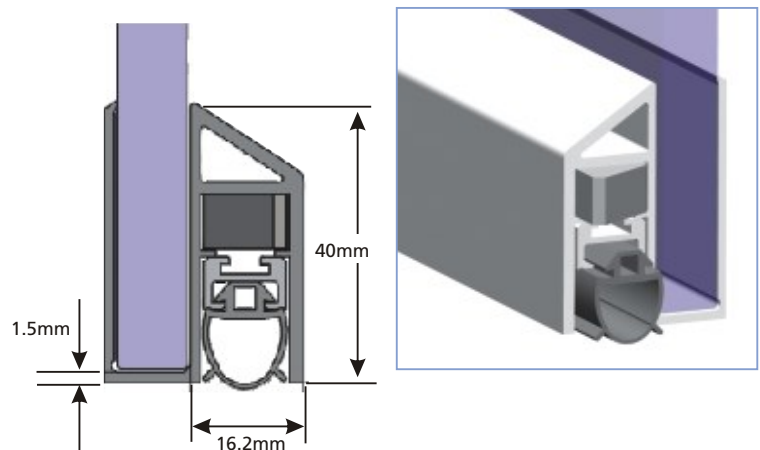

Enlarged view showing Part No DUO GS-10



Installation to the opening surface of the door

Finishes

Available in anodised aluminium

Sealing System for Glass Doors

Purpose made / OEM / Under door fit

- Automatic door seal for 8mm, 10mm, 20mm all-glass doors in buildings.
- Aluminium outer case 13mm x 32/47mm for 8 and 10mm versions, outer case 25.5mm x 33/68mm for 20mm version.
- Install at centre beneath the door leaf
- Self-extinguishing silicone seal

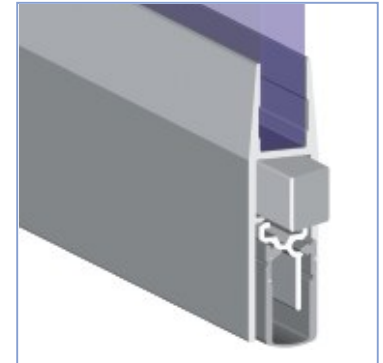
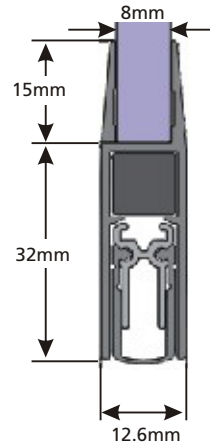

For 8mm glass doors

Part Numbers

Sound-Ex DUO GS-H8 (for 8mm glass)
Double actuation

Sound-Ex GS-H8 (for 8mm glass)
Single actuation

Sound-Ex DUO GS-H10 (for 10mm glass)
Double actuation

Sound-Ex GS-H10 (for 10mm glass)
Single actuation

Sound-Ex DUO GS-H20 (for 20mm glass)
Double actuation

Sound-Ex GS-H20 (for 20mm glass)
Single actuation

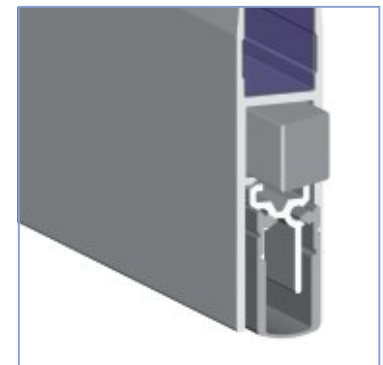
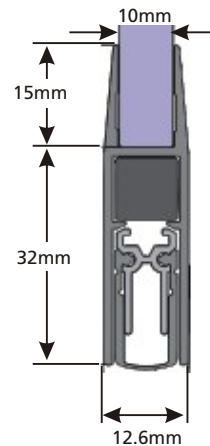

For 10 mm glass doors

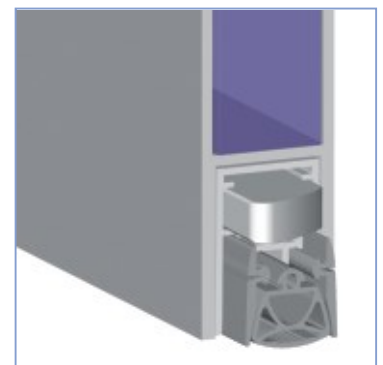
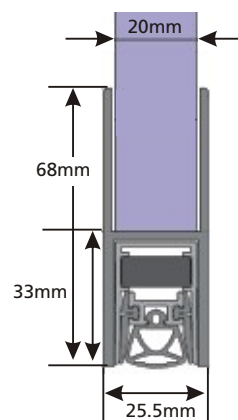

For 20 mm glass doors

Finishes

Available in silver anodised aluminium

Architectural Ironmongery for Glass Doors

Fitting instructions for door seals

Sound-EX DUO GS-8 and GS-10

Sound-EX GS-8

1 Available in single or double actuation

Sound-EX DUO GS-H - 8mm/10mm/20mm

Sound-EX GS-H - 8mm/10mm/20mm

1a Available in single or double actuation

actuator accessory

actuator

1b Accessory included for steel frames

2 Fitter can change seal from DIN left to DIN right - for only DUOGS8 and GS8 models

3 Use only adhesive and sealants approved by glass manufacturer

24h

3a Allow 24 hours for adhesive to dry

Door stop

max. 11mm

32mm

min 42mm

4 Door stops should butt against glass not door seal as they will cause damage

Maximum travel 11mm
 Maximum gap between door and frame 10mm
 Installation
 First adjust inside
 Then lock side.
 Pull out activator and turn

5 Installation

Anti-clock wise gives more travel

Clock-wise gives less travel of seal

5a Adjusting travel on door seals

The door seal should be pressed against the floor uniformly over the entire door leaf width

5b Pressure of door seal against floor

Brushes

Brush for horizontal edge or retrofit applications

Brushes can be adhered to doors of any thickness

Brush for vertical edge or OEM applications

- For 8mm or 10mm glass doors
- Silver anodised aluminium profile
- PP-Brush for 2 different closing gap widths 15mm or 20mm
- Can be cut to length

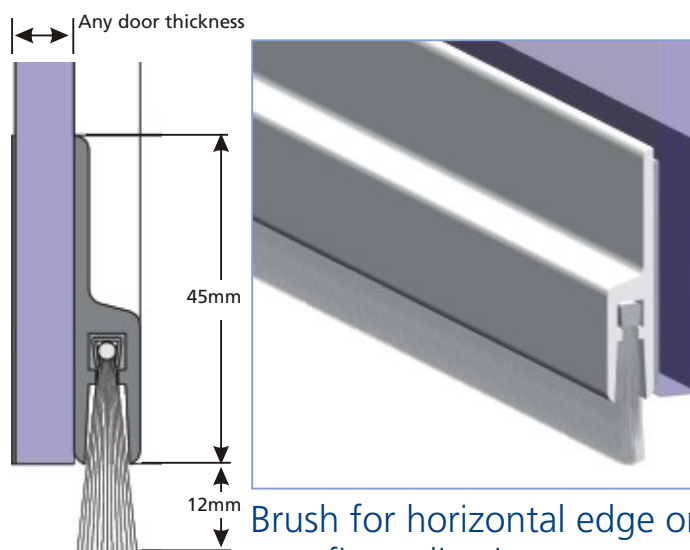

Brush for horizontal edge or retrofit applications

Fitting options

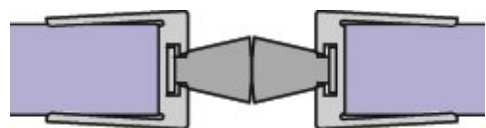

Vertical fitting inside face



Horizontal fitting inside face



Horizontal fitting outside face

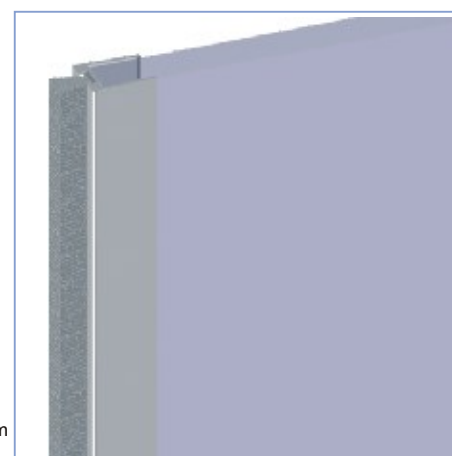
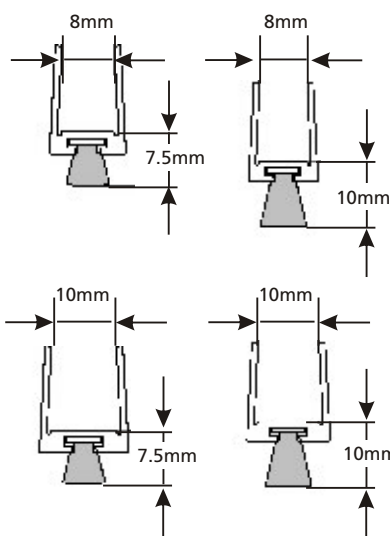

Brush for vertical edge or OEM applications

Architectural Ironmongery for Glass Doors

